

PILE DRIVER (TILTING TYPE)

World Patent Product **DPD Tilting Series**



- 30% better efficiency than general type
- 90-degree tilting function
- Easy & accurate control for tilting operation system by operator alone with joystick
- Proven safety by safe control system

- 90-degree tilting function in operating sheet pile, H-beam, tube & steel can be easily controlled without additional assistant worker. Labor cost for one person can be saved
- Maximizing working performance and productivity by its much more enhanced tilting function
- Best impulse and clamping power
- Sharply reduces costs for transportation and assistant worker
- Highly improved piling operation method
- Extended lifetime by using special bearings designed for high frequency vibration
- High technology special elastomers (Patent) absorb vibration shock and protect the excavator from damage
- With minimum noise by special elastomers properly manage works at crowded areas, at narrow roads, at center of the city and under the bridges
- Easy installation using hydraulic breaker lines of the excavator and electric control cable



Specification

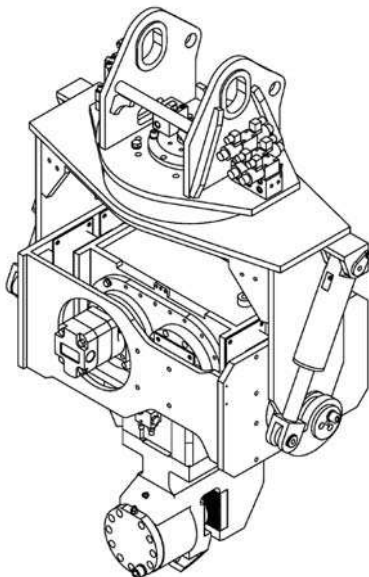
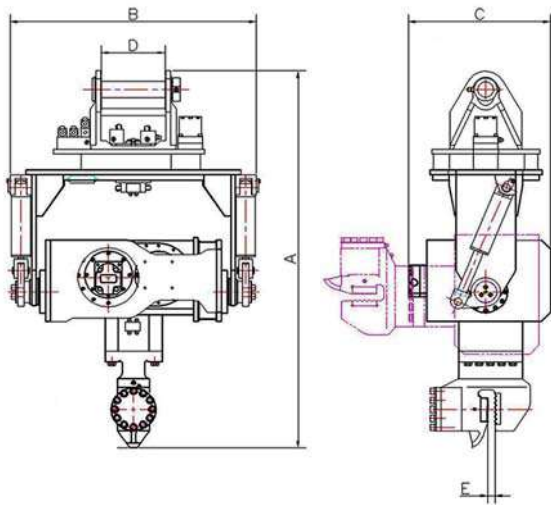

Model		Units	DPD350T	DPD600T	DPD700T	DPD850T	
Eccentric Moment		in.lbs	304	530	608	738	
		kgm	3.5	6.1	7	8.5	
Frequency		vpm	3000	2750	2700	2700	
Centrifugal Force		lb	67443	112404	125893	152870	
		kN	300	500	560	680	
Amplitude		in	0.27	0.35	0.55	0.63	
		mm	6.8	8.8	14	16	
Working Pressure		kg/cm ²	200	250	250	250	
		psi	2900	3600	3600	3600	
Max. Hydraulic Pressure		kg/cm ²	250	270	270	270	
		psi	3600	3900	3900	3900	
Oil Quantity		l/min	180	220	330	330	
		gpm	48	58	87	87	
Hydraulic Power		kw	60	153	177	177	
		hp	79	201	241	241	
Dimension	Height (A)	in	82.6	82.6	93.6	93.7	
		mm	2100	2100	2380	2380	
	Length (B)	in	52	53.7	57.5	58.4	
		mm	1320	1363	1460	1484	
	Width (C)	in	30	29.8	30.7	30.7	
		mm	762	757	780	780	
	Upper Pin (D)	in	13.5	13.5	13.5	13.5	
		mm	345	345	345	345	
	Clamping Jaw (E)	in	1.6	1.6	1.6	1.6	
		mm	40	40	40	40	
	Turning		degree	360	360	360	360
	Tilting		degree	90	90	90	90
Weight	Main Body	lb	4211	4519	5644	5952	
		kg	1910	2050	2560	2700	
	Extension Boom	lb	1298	1386	1452	1452	
		kg	590	630	660	660	
Applicable Excavator		Ton	23~32	30~40	36~45	42~50	

※ Materials and specifications are subject to change without prior notice